

ez-DSK

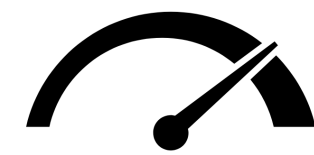

LIVE CG GENERATOR

Zero Delay and Reclocking



Down stream keying technology overlays the fill and key over the outgoing video stream causing zero delays. All ez-DSK outputs reclock outgoing video boosting your video quality and synchronization.

ez-DSK allows easy application of computer graphics like subtitles, images, sequences, videos and widgets into your outgoing video source. Overlay method of ez-DSK doesn't take any extra video ports like conventional Fill/Key generators and allows zero delay transmission. It is equipped with fail safe trigger mechanism to prevent any disruption if any malfunction occurs. All outgoing ports reclock the video source for better quality video. ez-DSK distributes the outgoing source into 4 SDI and 1 HDMI, so it works as a distributor and a converter at the same time.



< Front >

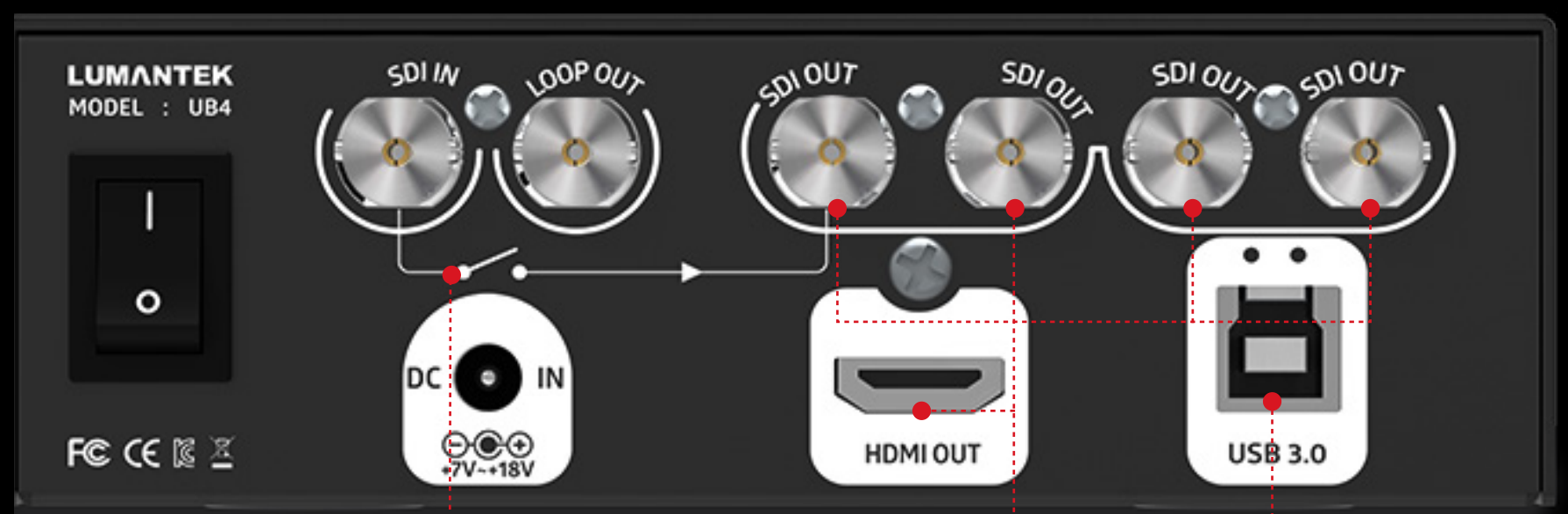

< Rear >

Fail Safe

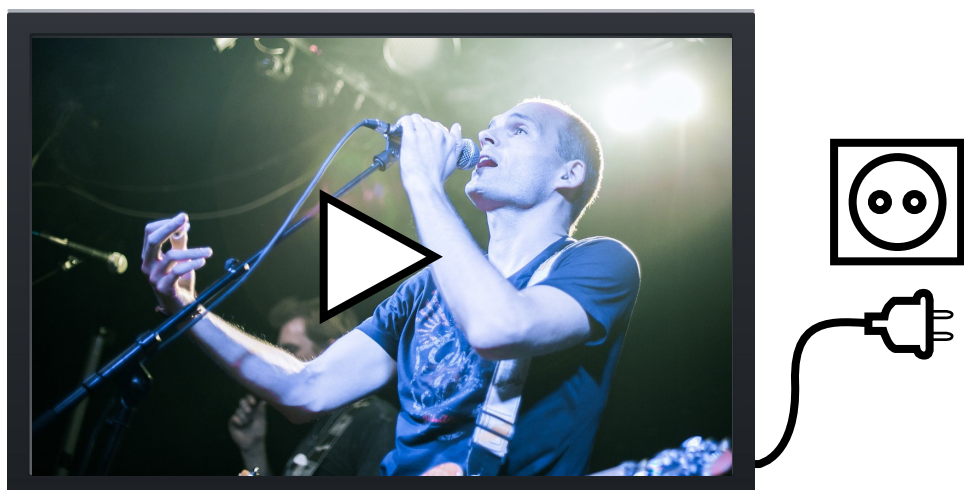

Feel safe with our Fail Safe mechanism. Your broadcasting won't fail even with powered off device due to malfunctioning or power outage (1 output). Also, ez-DSK itself generates streaming source which will prevent any disruptions to subsequent broadcasting equipment even when the original input signals are out.

Distributor and Converter

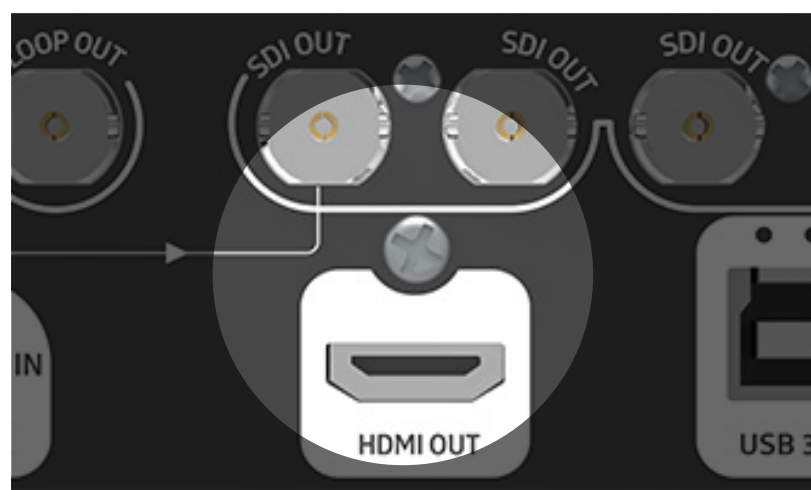

ez-DSK distributes the video into 1 Clean source and 5 CG'ed sources (4 SDI & 1 HDMI). You do not need an extra distributor or a converter for HDMI output.

CG software, ez-CGER



Use our dedicated complimentary software, ez-CGER, to create & overlay your CG's. Add images, videos, sequences, texts and more to your videos.

gs@lumantek.com
www.lumantek.com

ez-DSK

L I V E C G G E N E R A T O R

System Specification

Data Input

SDI Input : (BNC 75Ω) x 1

SD : 480i59/ 576i50

HD : 1080p30/1080p29/1080p25/1080p24/1080p23/

1080i60/1080i59/1080i50/720p60/720p59/720p50

Full HD : 1080p60/1080p59/1080p50

CG Input : (USB3.0) x 1

HD : 1080p30/1080p29/1080p25

1080i60/1080i59/1080i50/720p60/720p59/720p50

Data Output

SDI Output : (BNC 75Ω) x 4

SD : 480i59/ 576i50

HD : 1080p30/1080p29/1080p25/1080p24/1080p23/

1080i60/1080i59/1080i50/720p60/720p59/720p50

Full HD : 1080p60/1080p59/1080p50

SDI Loop Output : (BNC 75Ω) x 1

- Same as input resolution

- Overlay feature is not supported

HDMI Output : (BNC 75Ω) x 1

SD : 480i59/ 576i50

HD : 1080p30/1080p29/1080p25/1080p24/1080p23/

1080i60/1080i59/1080i50/720p60/720p59/720p50

Full HD : 1080p60/1080p59/1080p50

Electrical

Power Consumption: 7W(max.)

Operation Temperature : 0 - 40°C

Power Input: DC 7 - 18V

Physical

Weight: 0.5 kg

Dimension: 44(H) X 140(W) X 119(D)